

## Stainless Steel (Non-Sealed) Bonnet Assembly – Rising Handwheel Indicator

### HC4 Diaphragm Valves

Intended for the Biotechnology and Pharmaceutical industries, this stainless steel bonnet assembly offers materials of construction suitable for high temperature, aggressive washdown and steam autoclave environments.

The bonnet shell and internals are manufactured from 18/8 (Austenitic) grade stainless to match the chemical and physical properties of the valve body.

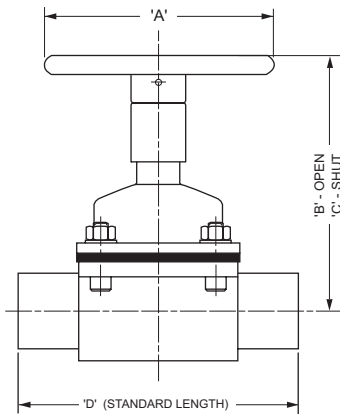

Cast Iron Epoxy Coated Handwheel

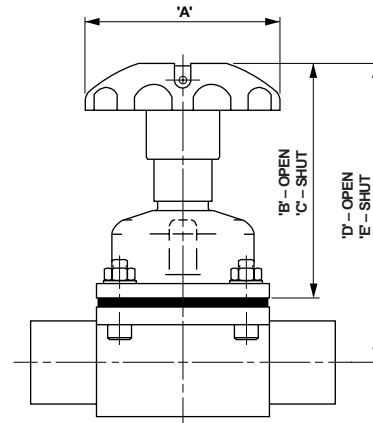

PES Handwheel

#### Cast Iron Epoxy Coated Handwheel

Size (DN)	A	B	C	D
2.50" (65)	6.69" (170mm)	9.41" (239mm)	8.15" (207mm)	8.54" (217mm)
3.00" (80)	9.06" (230mm)	10.24" (260mm)	8.86" (225mm)	10.00" (254mm)
4.00" (100)	11.02" (280mm)	12.72" (323mm)	11.06" (281mm)	12.95" (329mm)
6.00" (150)	14.49" (368mm)	17.52" (445mm)	14.76" (375mm)	15.98" (406mm)

#### PES Handwheel

Size (DN)	A	B	C	D	E
0.50" (15)	2.44" (62mm)	2.76" (70mm)	2.48" (63mm)	3.46" (88mm)	3.19" (81mm)
0.75" (20)	2.44" (62mm)	2.76" (70mm)	2.52" (64mm)	3.58" (91mm)	3.35" (85mm)
1.00" (25)	3.15" (80mm)	3.50" (89mm)	3.11" (79mm)	4.49" (114mm)	4.09" (104mm)
1.50" (40)	4.72" (120mm)	5.12" (130mm)	4.45" (113mm)	6.46" (164mm)	5.79" (147mm)
2.00" (50)	4.72" (120mm)	5.71" (145mm)	4.76" (121mm)	7.28" (185mm)	6.34" (161mm)

HC4/110/01/11.02

### Size Availability

- AFP/A Type valves 0.50"-6.00" (DN15 to DN150)

### Standard Features

- Rising handwheel
- Yellow visual indicator to show open/closed valve position

### Material of Construction

- Bonnet – Stainless steel, BS EN10088-3 electropolished
- Spindle – Stainless Steel grade 1.4057
- Indicator Sleeve – Polypropylene
- Handwheel –  
0.50"-2.00" (DN15-50): PES (Polyethersulphone)  
2.50"-6.00" (DN65-150): Cast iron epoxy coated
- Compressor – Stainless Steel  
½"-2" (DN15-50): BS 3100 304C15  
2½"-6" (DN65-150): BS 3100 316C16

### Temperature Rating

Maximum autoclave recommended temperature 266 °F (130 °C) – 0.50"-2.00" (DN 15-50) only

### Biopharm Compatibility

Materials of construction are FDA compliant.

Stainless steel and PES are suitable for wash-down with detergents, sodium hydroxide, hypochlorite, alcohols, dilute acids and autoclaving.

For other chemicals not stated above, contact the manufacturer.

### Recommended Bolting Torques

Size (DN)	Torque (Nm)
0.50" (15)	3.7 lbf ft (5)
0.75" (20)	3.7 lbf ft (5)
1.00" (25)	4.4 lbf ft (6)
1.50" (40)	9.6 lbf ft (13)
2.00" (50)	18.4 lbf ft (25)
2.50" (65)	25.8 lbf ft (35)
3.00" (80)	36.9 lbf ft (50)

For attachment to valve body the preceding torques are recommended, and should not be exceeded.

### Stainless Steel Bonnet – Tank, Zero Dead Leg and Diverter Valve Options

The bonnet is attached to Tank Bottom, Zero Dead Leg T & L, Diverter Valves by means of studs.

### Maximum Pressure Rating

- 0.50"-2.00" (DN15-50):  
rubber diaphragm: 232 psi (16 bar)  
hi-steam PTFE diaphragm: 232 psi (16 bar)  
all other PTFE diaphragms: 145 psi (10 bar)
- 2.50" & 3.00" (DN65 & 80):  
all diaphragm types: 145 psi (10 bar)

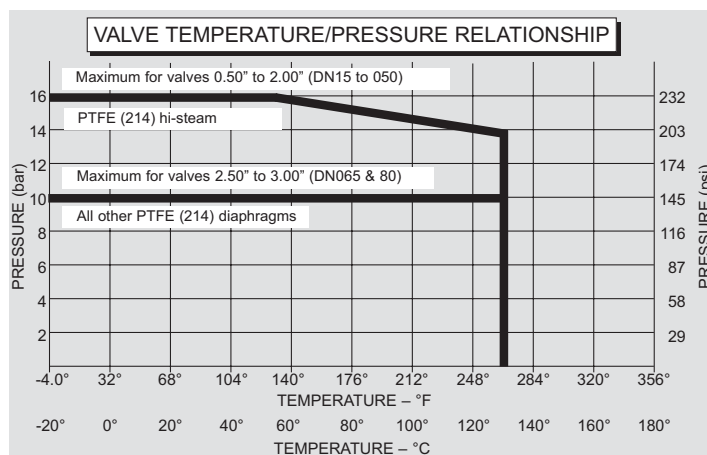

Crane Process Flow Technologies  
Saunders HC4 Products  
9860 Johnson Road  
Montgomery, Texas 77316  
www.cranesaunders.com  
PH 936-588-4447  
Fax 936-588-8302